





A PLAYCORE Company
1-800-235-2440

3261

SENSORY WATERSPOUT

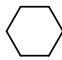
ISSUED/REVISED: 2/14/2017

-  = INSTALLATION
DETAIL
-  = PARTS LIST
REFERENCE

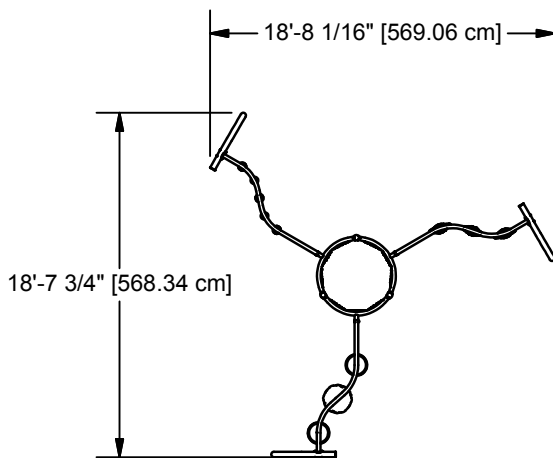
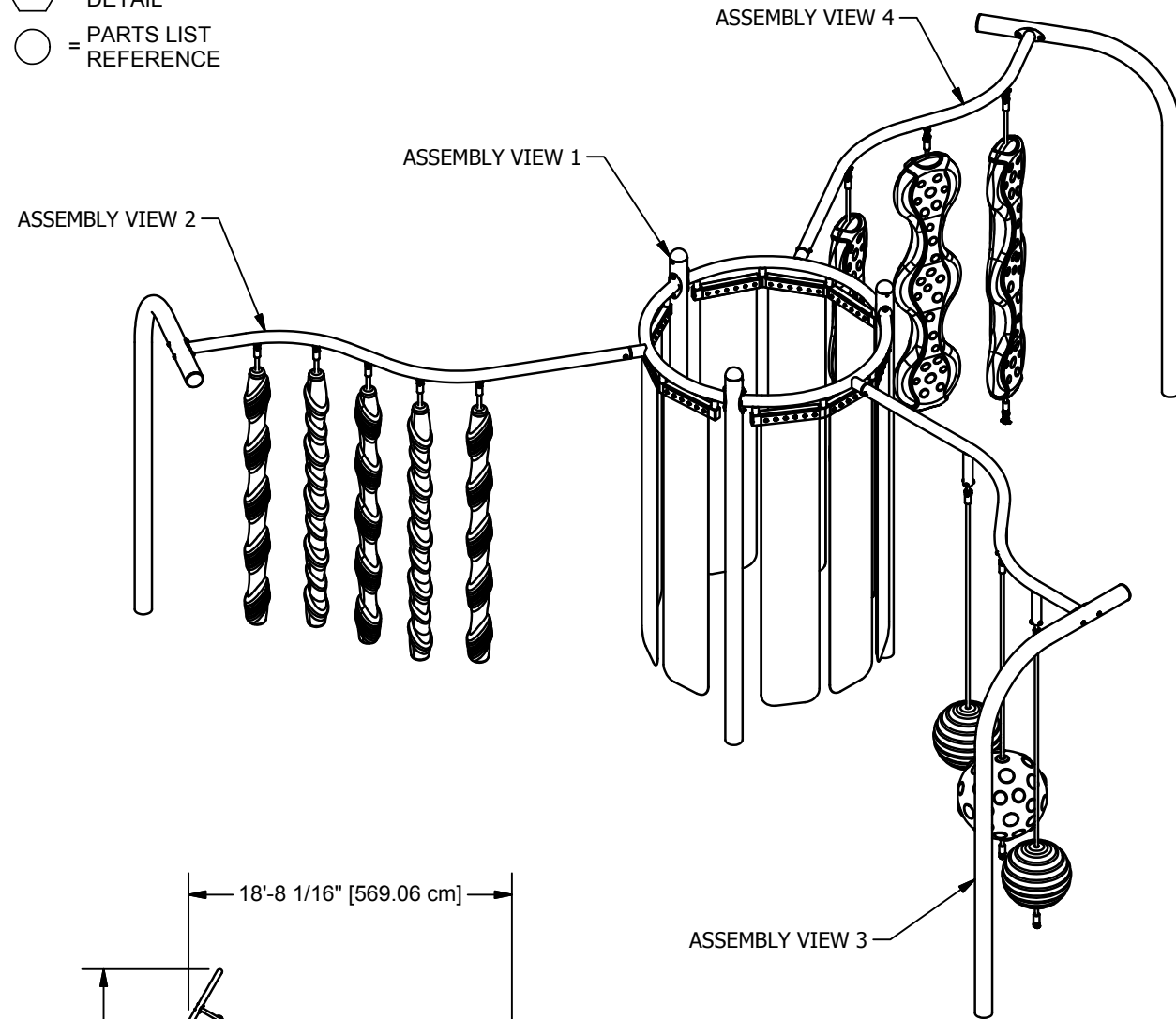

TOP VIEW

ASSEMBLY DRAWING

Parts List			
REF.	DESCRIPTION	QTY	PART NUMBER
1	UPRIGHT w/ INSERTS	3	15AFMG
2	CANTILEVERED UPRIGHT	3	313757
3	SENSORY VORTEX TOP RAIL ASS'Y	3	313872
4	GREEN CURTAIN	3	313911
5	RED CURTAIN	6	313910
6	SENSORY VINES TOP RAIL HORIZONTAL/SOCKET ASS'Y	1	314103
7	SENSORY VINES WAVY AND SPIRAL ROPE w/CABLE	3	313730
8	SENSORY VINES WAVY ROPE w/CABLE	2	313733
9	SENSORY WATERDROP TOP RAIL ASS'Y	1	313927
10	18" SENSORY WATERDROP	1	313731
11	14" SENSORY WATERDROP	2	313732
12	SENSORY WATERFALL HORIZONTAL/SOCKET TOP RAIL	1	314078
13	SENSORY WATERFALL ASS'Y (TETHERED)	2	313902
14	SENSORY WATERFALL	1	313737
15	MACHINED CAP	3	313933
16	3 1/2" MOLDED CAP	3	212340
	HARDWARE COMPLETE	1	212776
	1/4" BARREL NUT	16	804809*
	5/16" x 1/2" S.S. SHOULDER BOLT	16	802740*
	5/16" x 2" P.B.H.C.S. w/PATCH	54	812046*
	5/16" STAINLESS STEEL BARREL NUT	54	804813*
	5/16" LOCK WASHER	54	817330*
	3/8" x 1/2" P.B.H.C.S. w/PATCH	9	812049*
	3/8" x 1 1/4" P.B.H.C.S. w/PATCH	12	812051*
	3/8" x 2" P.B.H.C.S. w/PATCH	3	812055*
	3/8" x 3 1/2" P.B.H.C.S. w/PATCH	6	812075*
	3/8" BARREL NUT	9	804804*
	3/8" FLAT WASHER	27	817410*
	3/8" FLAT WASHER (1 1/4" O.D.)	8	817424*
	3/8" LOCK WASHER	30	817334*
	WATERDROP MACHINED SHAFT	3	313934*
	CHAIN	5	313901*
	3/8" SWIVEL PLUG	5	313898*
	MEDIUM LOAD SPRING	3	818377*
	MOUNTING PLATE	18	313825*
	STEEL COMPRESSION SPRING	3	818378*
	STAINLESS STEEL SWIVEL	5	818375*
	OIL-EMBEDDED FLANGED SLEEVE BEARING	3	818376*

Unless Otherwise Specified, All Units of Measure are Each
* Included in Hardware

Warning: During Installation, Hardware And Small Parts Are Choking Hazards For Young Children. Store Unused Parts Appropriately Until Assembly Is Completed. Once Assembly Is Completed, Remove Any Unused Parts From The Play Environment And Dispose/Save Them In A Secure Location.

Note: Peen Tee-Nuts and Flatwashers to match radius of pipe after assembly is complete.

Note: Loctite (supplied by others) should be used on any non-patch hardware.

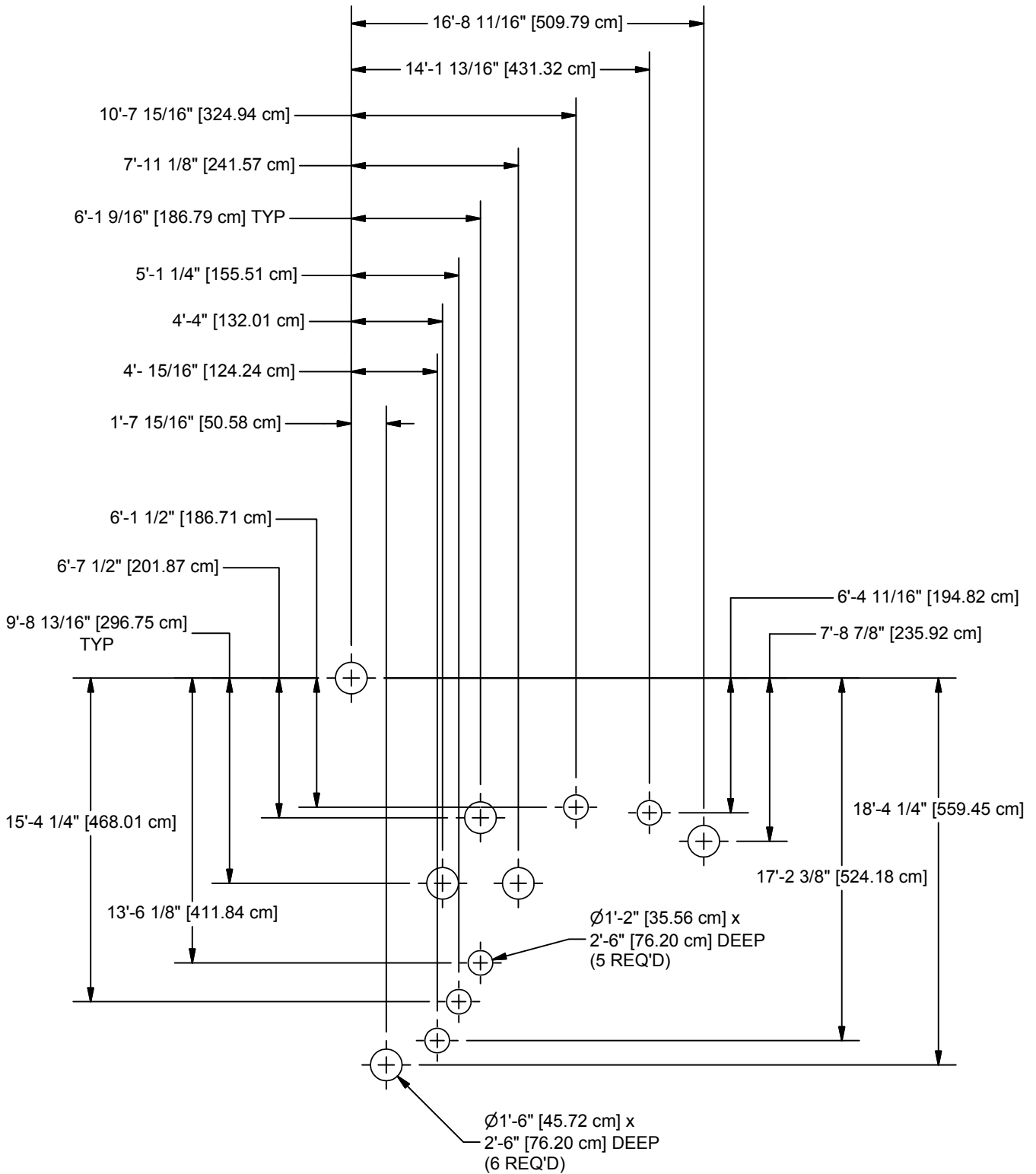

NOTE: HOLE DEPTHS INDICATED ON ALL GROUND PLANS ARE MEASURED FROM THE FINISHED SURFACE. SEE DETAIL 003. ALL FOOTING DIMENSIONS ARE BASED ON LEVEL FINISHED SURFACE.

GROUND PLAN

CONCRETE REQUIRED
.89 CUBIC YARDS
[.68 CUBIC METERS]

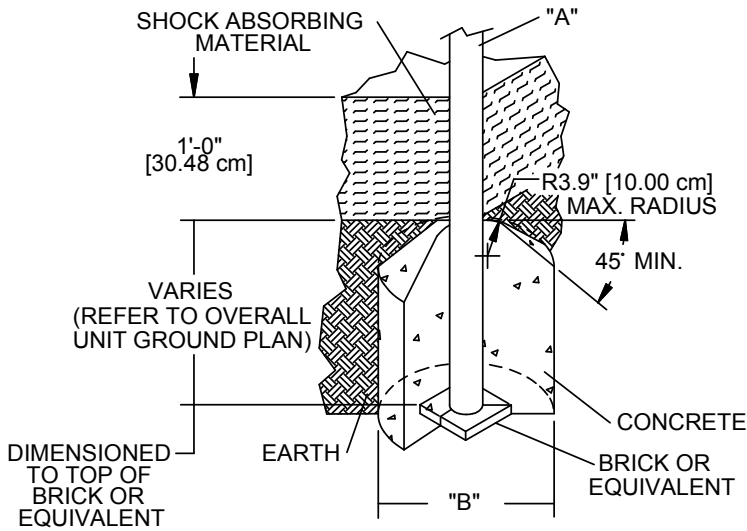

003

DIA. "A" (PIPE SIZE)	DIA. "B" (FOOTING SIZE)
1 1/4" [3.18 cm]	1'-2" [35.56 cm]
1 1/2" [3.81 cm]	1'-2" [35.56 cm]
1 5/8" [4.13 cm]	1'-6" [45.72 cm]
1 7/8" [4.83 cm]	1'-6" [45.72cm]
3 1/2" [8.89 cm]	1'-6" [45.72cm]
5" [12.70 cm]	1'-6" [45.72cm]

SHOCK ABSORBING PROPERTIES OF SURFACING MATERIALS VARY. IF YOU DETERMINE THAT LESS THAN 1'-0" [30.48cm] OF SURFACING IS REQUIRED, MAKE UP THE DIFFERENCE IN ELEVATION WITH EARTH, BEFORE APPLYING SURFACING.

NOTES:

- SLOPED FOOTING IS A REQUIREMENT OF EUROPEAN STANDARD EN1176-1
- SUGGESTED MINIMUM CONCRETE RATING: 3000 PSI

INSTALLATION INSTRUCTIONS

NOTE: THIS INSTALLATION BOOKLET SHOULD BE KEPT IN CUSTOMER'S FILE FOR FUTURE REFERENCE.

NOTE: Do not overtighten bolts. To overtighten may cause buckling or dimpling of some parts.

NOTE: Read installation instructions thoroughly before starting assembly. Pour concrete only after final assembly is complete. Bracing material may be required during assembly. **NOTE:** Do not tighten any nuts, bolts, rods, etc. until the unit is completely assembled.

NOTE: Assembly and leveling time will be greatly reduced if a transit is used to set location and depth of ground holes.

NOTE: Due to extremes in weather and soil conditions, hole sizes may have to be increased to meet local conditions

1. Locate and dig footing holes according to the Ground Plan. See Detail 003.

2. Drive 3-1/2" Molded Cap into short end of Cantilevered Uprights. See Detail 608.

3. Place Uprights w/ Inserts into the three central footing holes. Place Cantilevered Uprights w/ Cap into the three outermost footing holes.

4. Attach Sensory Vortex Top Rail Ass'y to Uprights w/ Inserts. See Detail 586

5. Attach Green and Red Curtains to Sensory Vortex Top Rail Ass'y using Mounting Plate. See Detail 556.

NOTE: See *Assembly View* for color alternation

6. Attach Top Rail Assemblies to Sensory Vortex Top Rail Ass'y and Cantilevered Uprights w/ Cap. See Detail 565 and Detail 594.

NOTE: Refer to *Assembly View* for placement of Top Rail Assemblies.

7. Attach Sensory Vines Wavy and Spiral Rope w/Cable and Sensory Vines Wavy Rope w/Cable to Sensory Vines Top Rail Horizontal/Socket Ass'y. (See Finished Assembly View for placement.) See Detail 560.

8. Attach Chain to bottom end of 18" and 14" Water Drops. See Detail 576.

9. Attach Water Drop Machined Shaft, Steel Compression Spring, Medium Load Spring, Bearing, and Machined Cap to the Sensory Water Drop Top Rail Ass'y. See Detail 577.

10. Attach top end of 18" and 14" Water Drops to Water Drop Machined Shaft . See Detail 578.

11. Attach Stainless Steel Swivel to Sensory Waterfall. See Detail 558.

12. Attach Chain to Sensory Waterfall Ass'y (Tethered). See Detail 557.

13. Attach Sensory Waterfall Ass'y (Tethered) and Sensory Waterfall to Sensory Waterfall Horizontal/Socket Top Rail. See Detail 559. (See Assembly View for placement.)

14. Plumb and level the entire assembly and tighten all fasteners.

15. After entire unit is assembled, pour concrete footings within 4" to the top and taper away from post for water drainage. Allow to cure at least 48 hours before use. Temporary bracing may be required until concrete cures.

16. When structure is finished and satisfactory, eliminate sharp points and edges (burring) on installed hardware like bolts, nuts, etc. Install resilient surfacing material within the use zone of play structure in accordance with ASTM specifications F1292 appropriate for the fall height of each structure. Refer to the safety guidelines.

SPECIFICATIONS

3-1/2" MOLDED CAP: The 3 1/2" Molded Cap shall be constructed from injection molded Low Density Polyethylene.

UPRIGHT W/ INSERTS: Shall be 3-1/2" O.D. with a 0.125" wall thickness 6061-T6 extruded seamless Aluminum tubing conforming to ASTM B- 221 and QQ-A 200/8. Tensile strength is 44,962 psi, and yield strength is 39,885 psi. Entire post is polyester powder-coated after fabrication. A cast aluminum cap of matching color is factory riveted into the top end using two aluminum rivets. All upright post shall have a finished grade line marking to indicate the correct playground safety surface level. All upright post shall be coated with a custom formula TGIC polyester powder coating in conformance with the specifications outlined herein.

CANTILEVERED UPRIGHT: Shall be fabricated from 3-1/2" outside diameter, 7 gauge (0.18") galvanized round tubing manufactured to ASTM A-500 Section 2 tolerances from cold-formed steel conforming to ASTM A-569 Sheet Spec for Steel Coil. Minimum yield strength shall be 50,000 psi and minimum tensile strength shall be 55,000 psi. The exterior surface is hot dip galvanized, chromate conversion coated, and a clear high performance organic polymer is applied. The inside diameter has 81% minimum zinc rich primer capable of providing excellent rust protection and fabrication characteristics. All coatings are applied inside and out after welding for superior corrosion protection throughout. Exterior surface galvanizing zinc purity is 99% as per ASTM B-6 high grade and special high grade. Galvanizing coverage shall demonstrate the ability to exceed 1000 hours salt spray corrosion exposure in accordance with ASTM B-117. Internal surface zinc rich 81% minimum zinc dust content in organic resin, as per ASTM F-1234, Section 5.2.4, Type D. All upright post shall have a finished grade line marking to indicate the correct playground safety surface level. All upright post shall be coated with a custom formula TGIC polyester powder coating in conformance with the specifications outlined herein.

SENSORY VINES WAVY AND SPIRAL ROPE w/CABLE:

Shall be manufactured with 5lb Polyurea spray (Playspray 274 Pure Green-B), 5lb Polyurea spray (Playspray 274A), 5lb Polyurethane foam (Playflex B) and 5lb Polyurethane foam (Playflex 100 A) materials. Cable shall be 19mm diameter UV protected polyimide (nylon) rope cable. 6 strands each containing nineteen steel reinforcing (0.6mm) strands within a polyimide sleeve wrapped around a reinforcing steel core containing 6 strands each containing nineteen steel reinforcing (0.4mm) steel strands.

SENSORY VINES WAVY ROPE w/CABLE:

Shall be manufactured with 5lb Polyurea spray (Playspray 274 Signal Yellow-B), 5lb Polyurea spray (Playspray 274A), 5lb Polyurethane foam (Playflex B) and 5lb Polyurethane foam (Playflex 100 A) materials. Cable shall be 19mm diameter UV protected polyimide (nylon) rope cable. 6 strands each containing nineteen steel reinforcing (0.6mm) strands within a polyimide sleeve wrapped around a reinforcing steel core containing 6 strands each containing nineteen steel reinforcing (0.4mm) steel strands.

SENSORY VINES TOP RAIL HORIZONTAL/SOCKET: The top rail shall be reinforced with an all welded construction fabricated from 2-3/8" O.D. x .095" (13 gauge) wall galvanized steel tubing and 1/2" x 2" hot rolled galvanized steel plate. The top rail shall be coated with a custom formula of TGIC polyester powder coating in conformance with the specifications outlined herein.

18" WATER DROP: Shall be manufactured with 4lb Polyurea spray (Playspray Red-B), 4lb Polyurea spray (Playspray 274 A), 4lb Polyurethane foam (Playflex B) and 4lb Polyurethane foam (Playflex 100 A) materials. Cable shall be 19mm diameter UV protected polyimide (nylon) rope cable with a calculated breaking load greater than or equal to 79.82kN: 6 strands each containing 19 steel reinforcing (0.4mm) steel strands; each end of the cable has an almag 35 aluminum machined tab casting. The sound chamber ass'y shall be an all welded construction fabricated from a 11 gauge (.120") hot rolled flat steel cap and a 5" outside diameter, 11 gauge (.120") round tubing. The sound chamber ass'y will contain .75" bells. The sound chamber ass'y will be held into place with almag 35 aluminum splicer casting.

14" WATER DROP: Shall be manufactured with 3lb Polyurea spray (Playspray Blue-B), 3lb Polyurea spray (Playspray 274 A), 4lb Polyurethane foam (Playflex B) and 3 lb Polyurethane foam (Playflex 100 A) materials Cable shall be 19mm diameter UV protected polyimide (nylon) rope cable with a calculated breaking load greater than or equal to 79.82kN: 6 strands each containing 19 steel reinforcing (0.4mm) steel strands; each end of the cable has an almag 35 aluminum machined tab casting. The sound chamber ass'y shall be an all welded construction fabricated from a 11 gauge (.120") hot rolled flat steel cap and a 5" outside diameter, 11 gauge (.120") round tubing. The sound chamber ass'y will contain .75" bells. The sound chamber ass'y will be held into place with almag 35 aluminum splicer casting.

SENSORY WATER DROP TOP RAIL ASS'Y:

Shall be an all welded construction fabricated from 3/16" x 4" hot rolled steel tab, 1-1/2" standard galvanized x .145" wall ASTM A-120 bendable quality pipe housing, and 2-3/8" O.D. x .095" (13 gauge) wall galvanized steel tubing top rail. The Sensory Water Drop Top Rail Ass'y shall be coated after fabrication with a custom formula of TGIC polyester powder coating in conformance with specifications outlined herein.

MACHINED CAP: Shall be manufactured with 1-5/8" O.D. cold roll steel.

CHAIN: Shall be manufactured with #80 4/0 straight link coil galvanized chain.

WATER DROP MACHINED SHAFT: Shall be manufactured with 304 stainless steel 1-1/4" O.D.

OIL-EMBEDDED FLANGED SLEEVE BEARING: Shall be manufactured with SAE 841 oil impregnated sintered bronze

MEDIUM LOAD SPRING: Shall be manufactured with blue, medium load chrome-silicon steel

STEEL COMPRESSION SPRING: Shall be manufactured with Zinc-Plated Steel

SENSORY WATERFALL: Shall be manufactured with 5lb Polyurea spray (Playspray 274 Red-B), 5lb Polyurea spray (Playspray 274A), 5lb Polyurethane foam (Playflex B) and 5lb Polyurethane foam (Playflex 100 A) materials. Cable shall be 19mm diameter UV protected polyimide (nylon) rope cable. 6 strands each containing nineteen steel reinforcing (0.6mm) strands within a polyimide sleeve wrapped around a reinforcing steel core containing 6 strands each containing nineteen steel reinforcing (0.4mm) steel strands.

SENSORY WATERFALL HORIZONTAL/SOCKET TOP RAIL: The top rail shall be reinforced with an all welded construction fabricated from 2-3/8" galvanized pipe and 1/2" x 2" hot rolled galvanized steel. The top rail shall be coated with a custom formula of TGIC polyester powder coating in conformance with the specifications outlined herein.

SENSORY VORTEX TOP RAIL ASS'Y: Shall be an all welded construction fabricated from 2-3/8" O.D. x .095" (13 gauge) wall galvanized steel tubing, 2-1/2" x 1-1/2" (14 ga.) square tubing, and 1-5/16" O.D. x .083" (14 gauge) wall galvanized steel tubing . The Sensory Vortex Top Rail Ass'y shall be coated after fabrication with a custom formula of TGIC polyester powder coating in conformance with specifications outlined herein.

MOUNTING PLATE: Shall be fabricated from 1/8" thick flat steel. The Mounting Plate shall be coated after fabrication with a custom formula of TGIC polyester powder coating in conformance with specifications outlined herein.

RED CURTAIN: Shall be 12" wide x .22" thick textured PVC curtain material. The 90 Shore A polyurethane top cover, combined with the friction impregnated bottom surface. Top cover finish is gloss.

GREEN CURTAIN: Shall be 12" wide x .11" thick textured PVC curtain material. The Green Curtain consist of a soft 35 Shore A durometer lattice top cover profile.

POWDER COAT FINISH: Shall be an electrostatically applied custom formula of TGIC polyester powder. All components will be free of sharp edges and excess weld spatter and shall be cleaned in a four stage solvent / zirconium based bath system (free of iron phosphate), as a rust inhibitor, and a zirconium conversion coating to prevent flash rusting before coating. In addition, all welds shall be protectively coated with ZRP, a zinc rich primer that forms a rust-resistant barrier layer over each weld prior to application of the powder coating. The powder coating shall have a super tough finish with maximum exterior durability and will have superior adhesion characteristics. Typical characteristics are: Two coat process to achieve 3.0 - 5.0 mil thickness and oven cured between 350 degrees Fahrenheit. Pencil Hardness H (ASTM D-3363), Impact (ASTM D-2794- 69), Wedge Bend (ASTM D-522-68), Adhesion (Cross Hatch ASTM D-3359 & Knife Scratch ASTM D-2197), Environmental (Stain Resistance ASTM D-1308, Humidity ASTM D-2247 - 87, Salt Spray ASTM B-117 & Fadometer 300 hrs with no loss of gloss), Over-bake Stability 100% at 350 degrees Fahrenheit for 10 minutes.

HARDWARE: All nuts, bolts, screws, inserts, and lockwashers used in the assembly of all play equipment, shall be stainless steel, yellow dichromate plated steel, blue-coat plated steel, mechanically galvanized or powder coated/yellow dichromate plated steel. All primary fasteners shall be 300 series stainless steel. Fasteners with yellow dichromate treatment have an electro deposited, 99.9% pure zinc substrate applied from a specially formulated solution sealed with a yellow dichromate top coat designed to work in conjunction with the zinc plating. Yellow dichromate has a 320% longer life to white corrosion and 275% longer to red corrosion than does hot-dip galvanizing. NOTE: All weights are based on average comparisons of each part.

SPECIFICATIONS: GAMETIME® has a policy of continuous improvement and reserves the right to discontinue or change specifications without notice.



IMPORTANT PRODUCT INFORMATION AND SAFETY WARNINGS



- All equipment should be installed on a soft, resilient, energy-absorbing ground surface. NEVER INSTALL PLAY EQUIPMENT ON CONCRETE OR ASPHALT. A fall on a hard surface can result in serious injury to the equipment user.
- ALWAYS FOLLOW INSTALLATION INSTRUCTIONS WHEN ERECTING EQUIPMENT.
- Worn surfaces around equipment should be restored. Concrete footings should never be exposed. Surface depth should comply with installation instructions.
- Equipment should be placed to eliminate conflicting traffic patterns.
- To reduce risk of clothing entanglement in compliance with ASTM F1487, any bolt end protruding more than two full threads beyond the face of the nut shall be cut-off, filed smooth and treated to prevent corrosion. Sharp edges on pipes should be capped or removed. Check for bent, broken or severely worn pipe and replace.
- Test overall stability and rigidity of all play equipment. Check for proper assembly, installation and ground anchoring.
- Check for and repair damage caused by wear or vandalism, a major factor in injury-causing situations.
- GameTime® PROVIDES ITS CUSTOMERS WITH COMPLETE SPECIFICATION SHEETS AND INSTALLATION INSTRUCTIONS. THE SPECIFICATION SHEET CONTAINS THE LISTING OF EVERY PART USED IN A PIECE OF EQUIPMENT AND SHOULD BE KEPT IN THE CUSTOMER'S FILES FOR ACCURATE REFERENCE WHEN REPLACEMENT PARTS ARE NEEDED.
- Never add components not intended for use with this product.
- Regular maintenance is necessary on this and all park and recreational equipment to ensure the safety of the user.
- Proper maintenance of GameTime® equipment requires regular tightening of all bolts, nuts, and set screws.
- All equipment should be free of rust and repainted whenever necessary to deter rusting.
- Regular checking of all parts, castings, etc. should be made. If a part is broken or worn it should be replaced immediately.
- Never use GAMETIME playground equipment around or in conjunction with swimming pools, ponds, lakes or any other bodies of water.
- Check to be sure all fittings are tight and that the bars and pipes do not move.
- A soft resilient surface should be placed under all swings, extending at least six feet beyond the farthest arc of the swing seat both front and back. NEVER INSTALL PLAY EQUIPMENT ON CONCRETE OR ASPHALT.

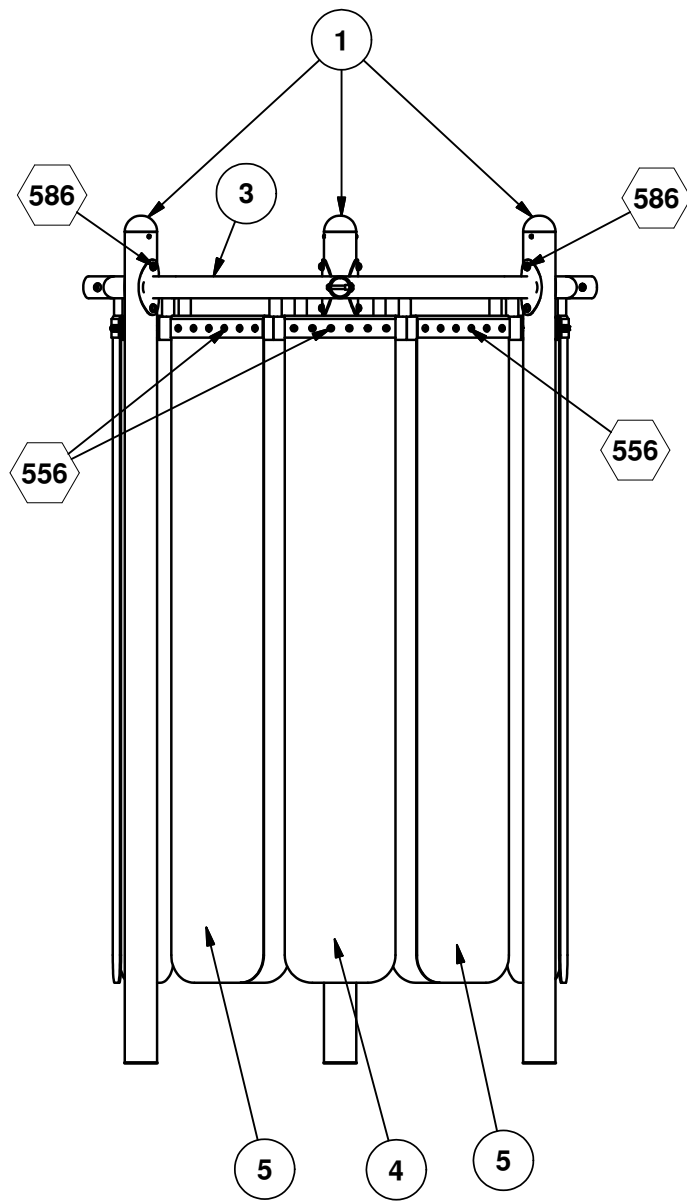

ASSEMBLY VIEW 1

DETAILS -for- ASSEMBLY VIEW 1

IMPORTANT

TO REDUCE THE RISK OF CLOTHING ENTANGLEMENT IN COMPLIANCE WITH ASTM F1487, ANY BOLT END
PROTRUDING MORE THAN TWO FULL THREADS BEYOND THE FACE OF THE NUT SHALL BE CUT-OFF FLUSH, FILED
SMOOTH AND TREATED TO PREVENT CORROSION.

NOTE: LOCTITE (SUPPLIED BY OTHERS) SHOULD BE USED ON ALL THREADED HARDWARE.

NOTE: AFTER ASSEMBLY IS COMPLETE, PEEN TEE-NUTS AND FLATWASHERS TO MATCH RADIUS OF PIPE.

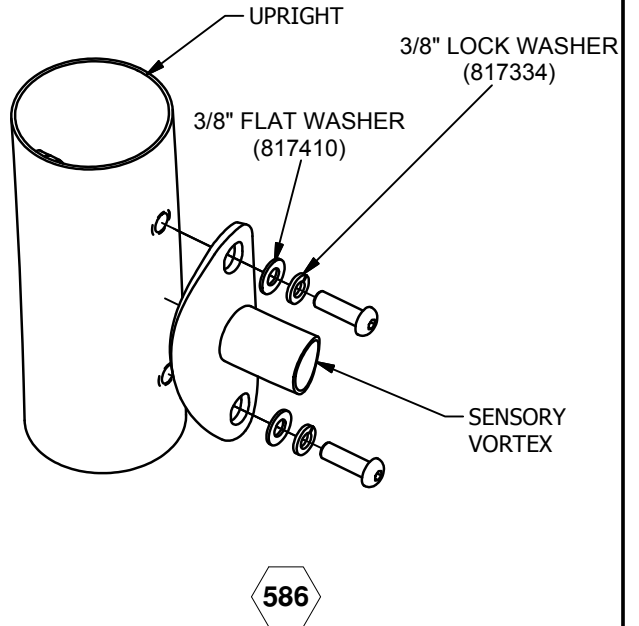
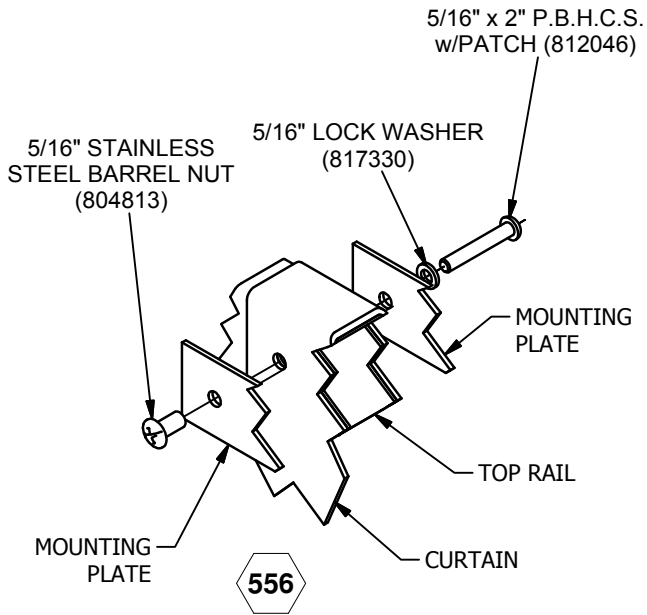
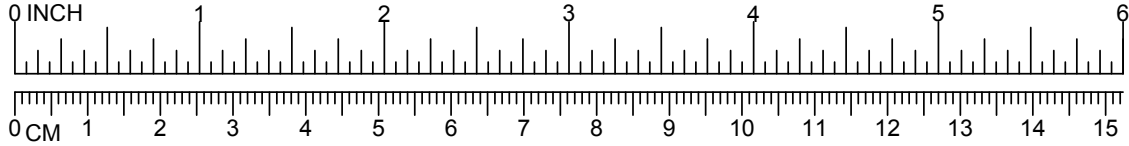

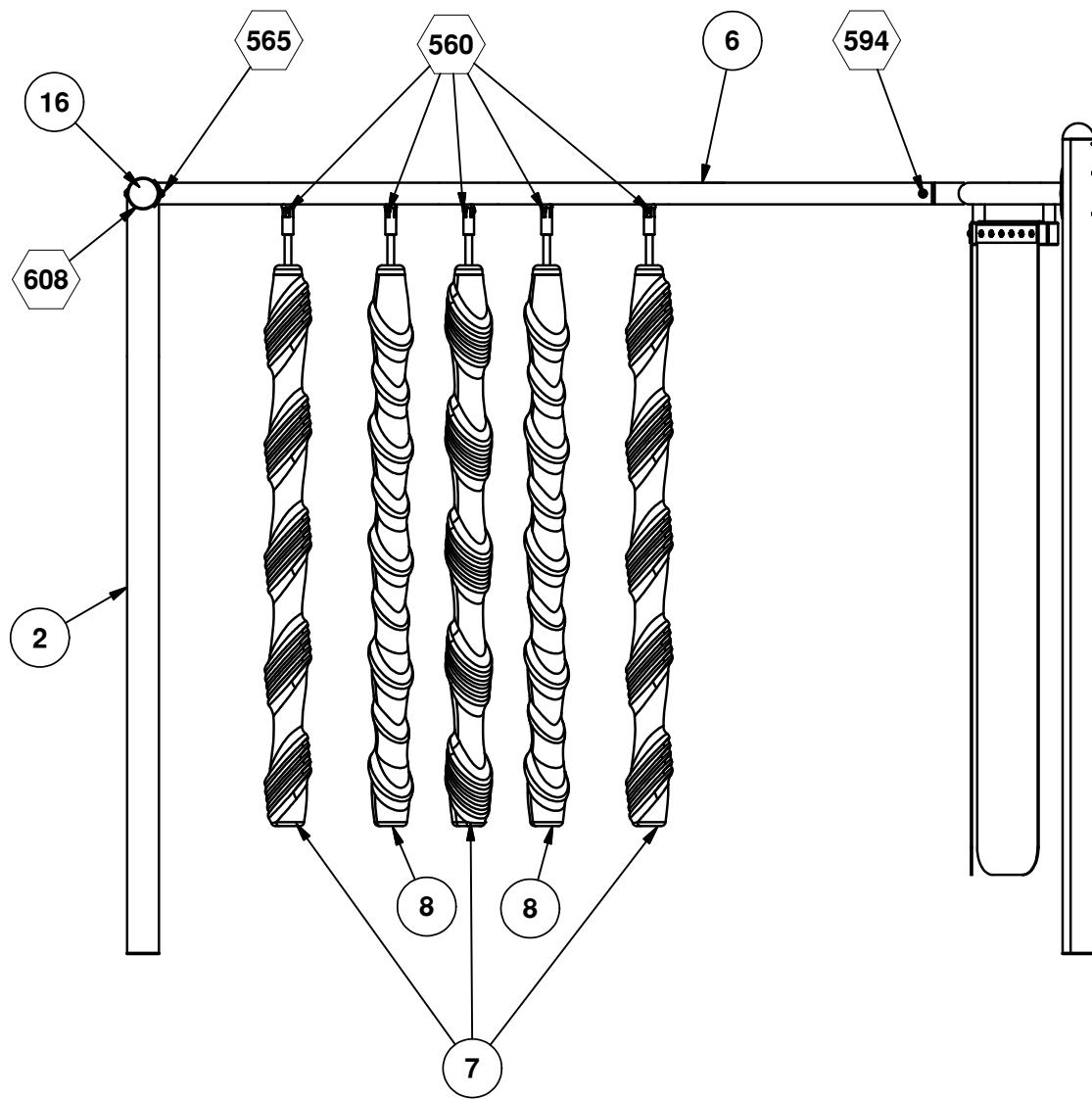

ASSEMBLY VIEW 2

DETAILS -for- ASSEMBLY VIEW 2

IMPORTANT

TO REDUCE THE RISK OF CLOTHING ENTANGLEMENT IN COMPLIANCE WITH ASTM F1487, ANY BOLT END
PROTRUDING MORE THAN TWO FULL THREADS BEYOND THE FACE OF THE NUT SHALL BE CUT-OFF FLUSH, FILED
SMOOTH AND TREATED TO PREVENT CORROSION.

NOTE: LOCTITE (SUPPLIED BY OTHERS) SHOULD BE USED ON ALL THREADED HARDWARE.

NOTE: AFTER ASSEMBLY IS COMPLETE, PEEN TEE-NUTS AND FLATWASHERS TO MATCH RADIUS OF PIPE.

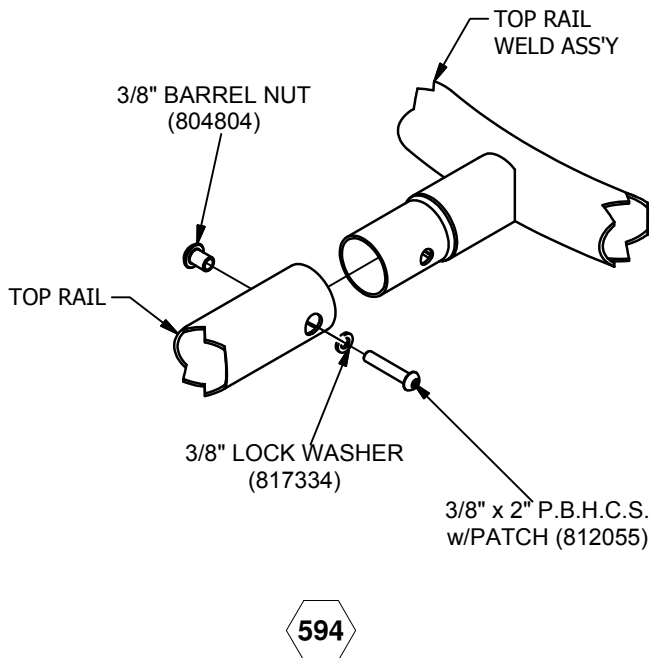
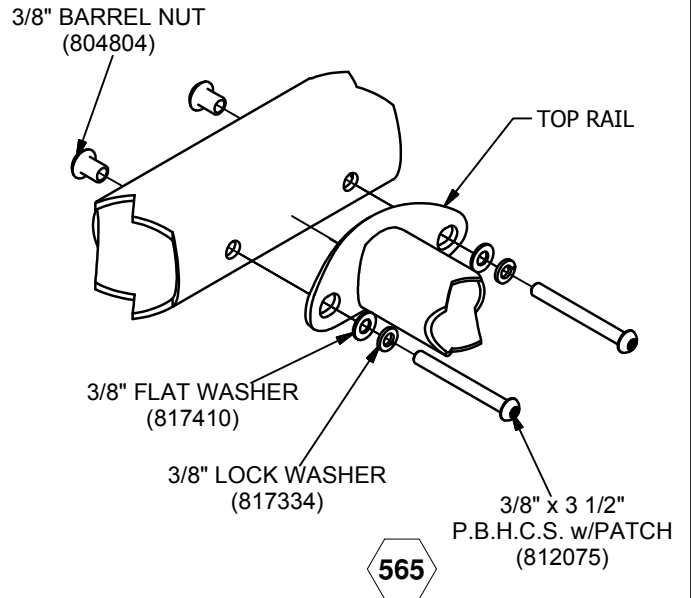
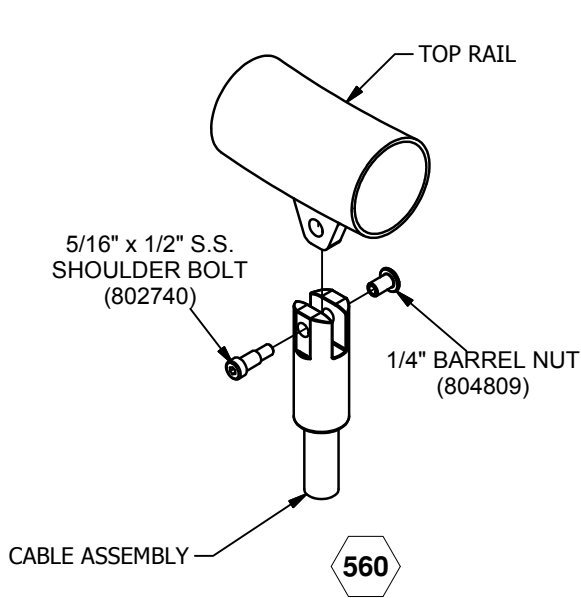
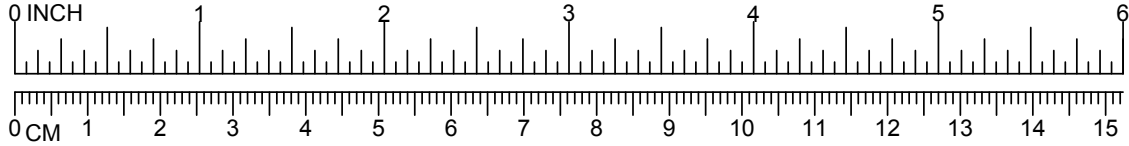

DETAILS -for- ASSEMBLY VIEW 2

IMPORTANT

TO REDUCE THE RISK OF CLOTHING ENTANGLEMENT IN COMPLIANCE WITH ASTM F1487, ANY BOLT END
PROTRUDING MORE THAN TWO FULL THREADS BEYOND THE FACE OF THE NUT SHALL BE CUT-OFF FLUSH, FILED
SMOOTH AND TREATED TO PREVENT CORROSION.

NOTE: LOCTITE (SUPPLIED BY OTHERS) SHOULD BE USED ON ALL THREADED HARDWARE.

NOTE: AFTER ASSEMBLY IS COMPLETE, PEEN TEE-NUTS AND FLATWASHERS TO MATCH RADIUS OF PIPE.

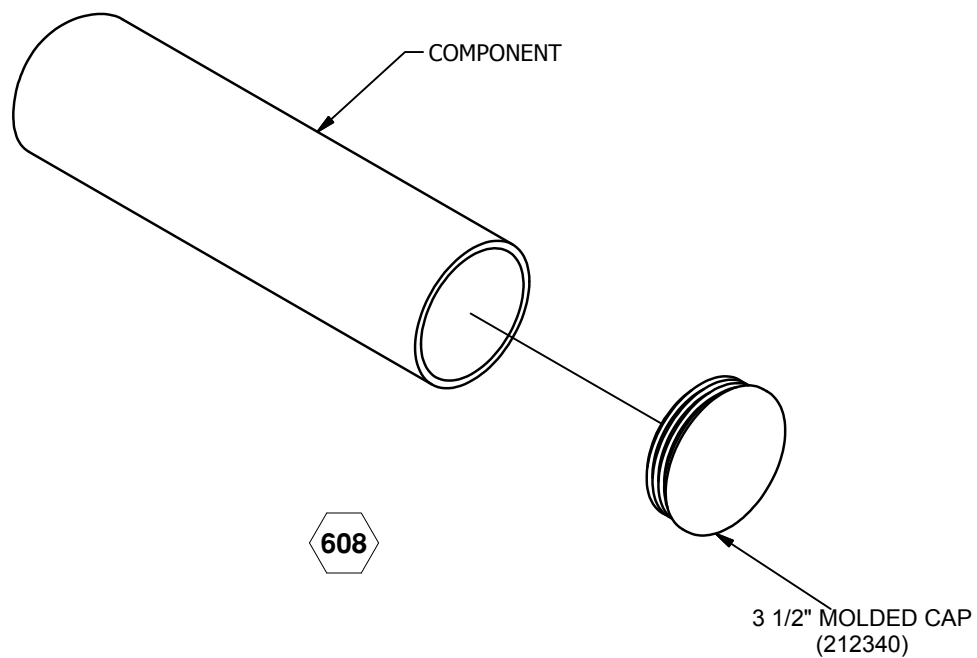
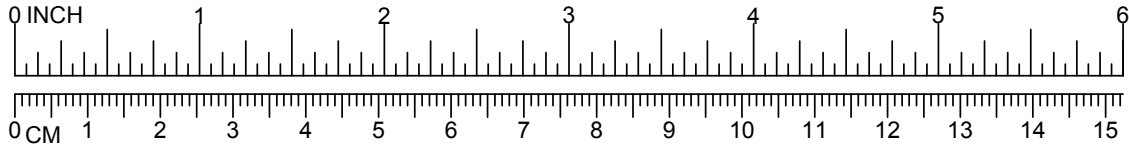

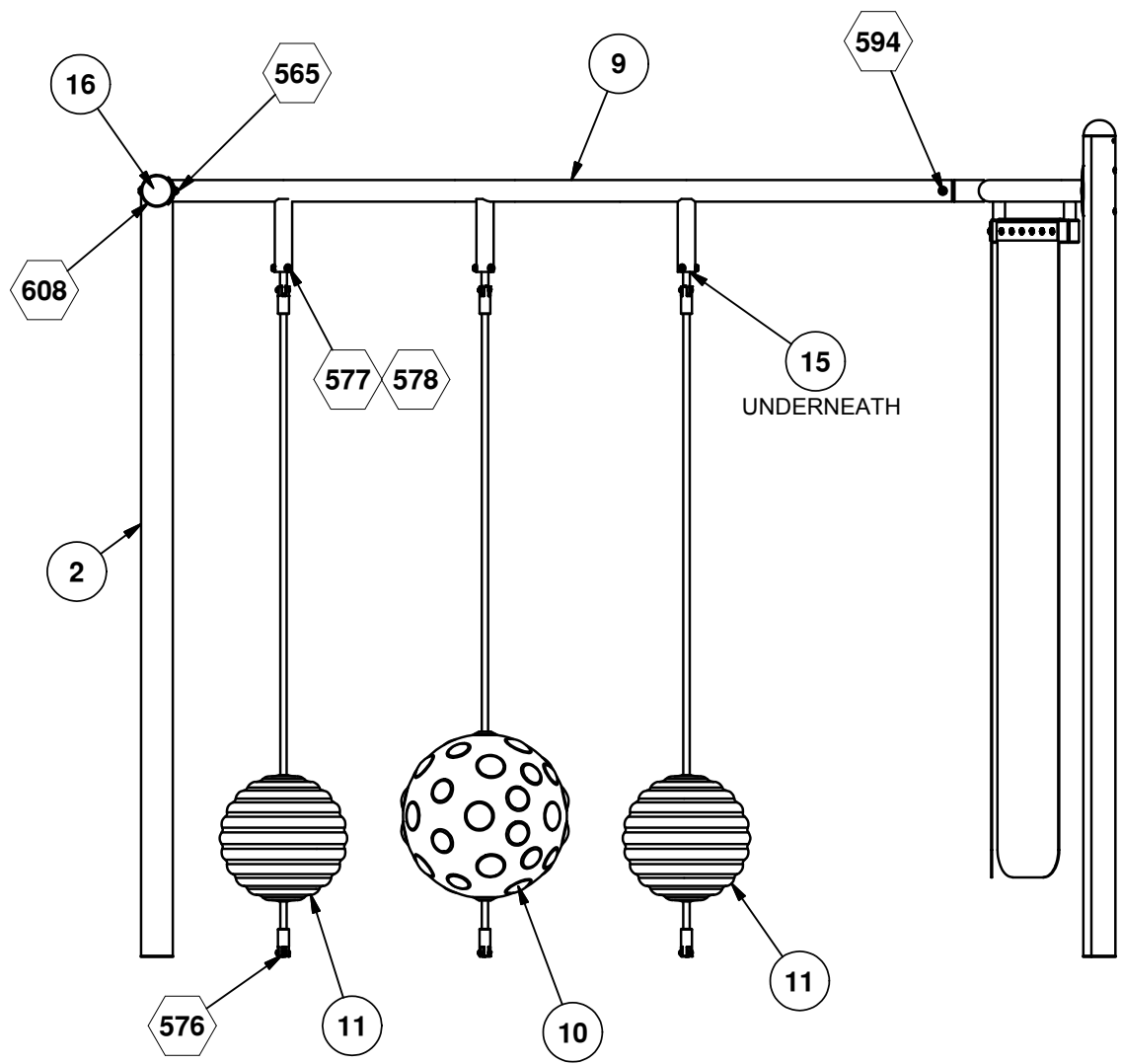

ASSEMBLY VIEW 3

DETAILS -for- ASSEMBLY VIEW 3

IMPORTANT

TO REDUCE THE RISK OF CLOTHING ENTANGLEMENT IN COMPLIANCE WITH ASTM F1487, ANY BOLT END
PROTRUDING MORE THAN TWO FULL THREADS BEYOND THE FACE OF THE NUT SHALL BE CUT-OFF FLUSH, FILED
SMOOTH AND TREATED TO PREVENT CORROSION.

NOTE: LOCTITE (SUPPLIED BY OTHERS) SHOULD BE USED ON ALL THREADED HARDWARE.

NOTE: AFTER ASSEMBLY IS COMPLETE, PEEN TEE-NUTS AND FLATWASHERS TO MATCH RADIUS OF PIPE.

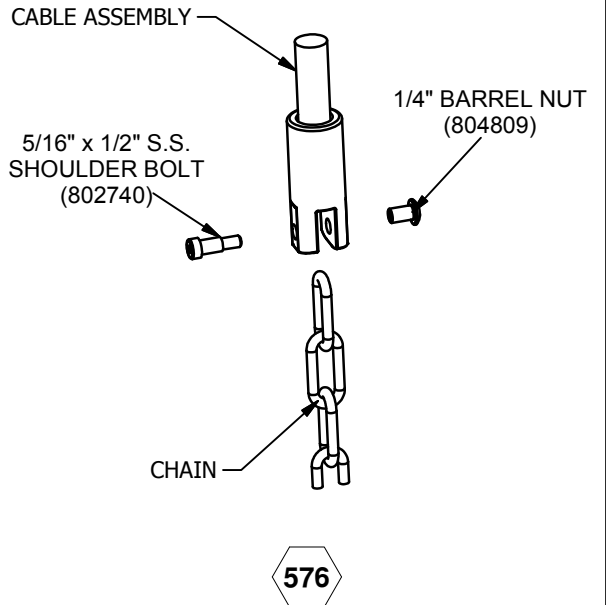
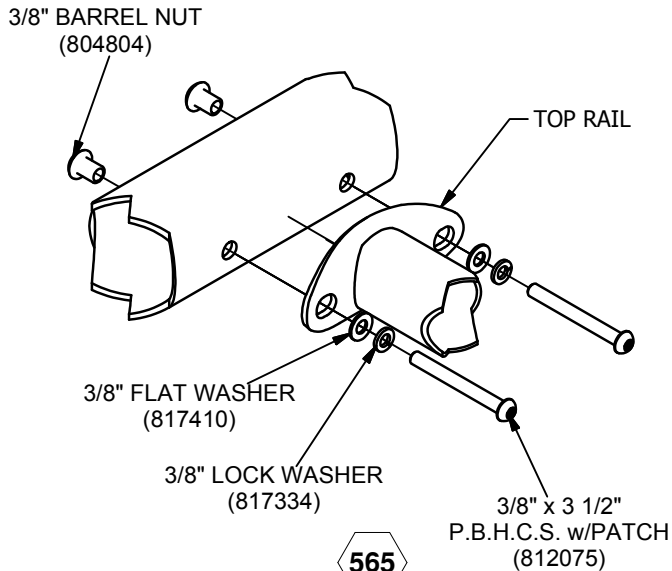
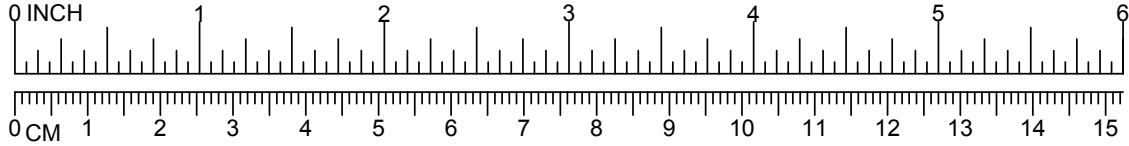

DETAILS -for- ASSEMBLY VIEW 3

IMPORTANT

TO REDUCE THE RISK OF CLOTHING ENTANGLEMENT IN COMPLIANCE WITH ASTM F1487, ANY BOLT END
PROTRUDING MORE THAN TWO FULL THREADS BEYOND THE FACE OF THE NUT SHALL BE CUT-OFF FLUSH, FILED
SMOOTH AND TREATED TO PREVENT CORROSION.

NOTE: LOCTITE (SUPPLIED BY OTHERS) SHOULD BE USED ON ALL THREADED HARDWARE.

NOTE: AFTER ASSEMBLY IS COMPLETE, PEEN TEE-NUTS AND FLATWASHERS TO MATCH RADIUS OF PIPE.

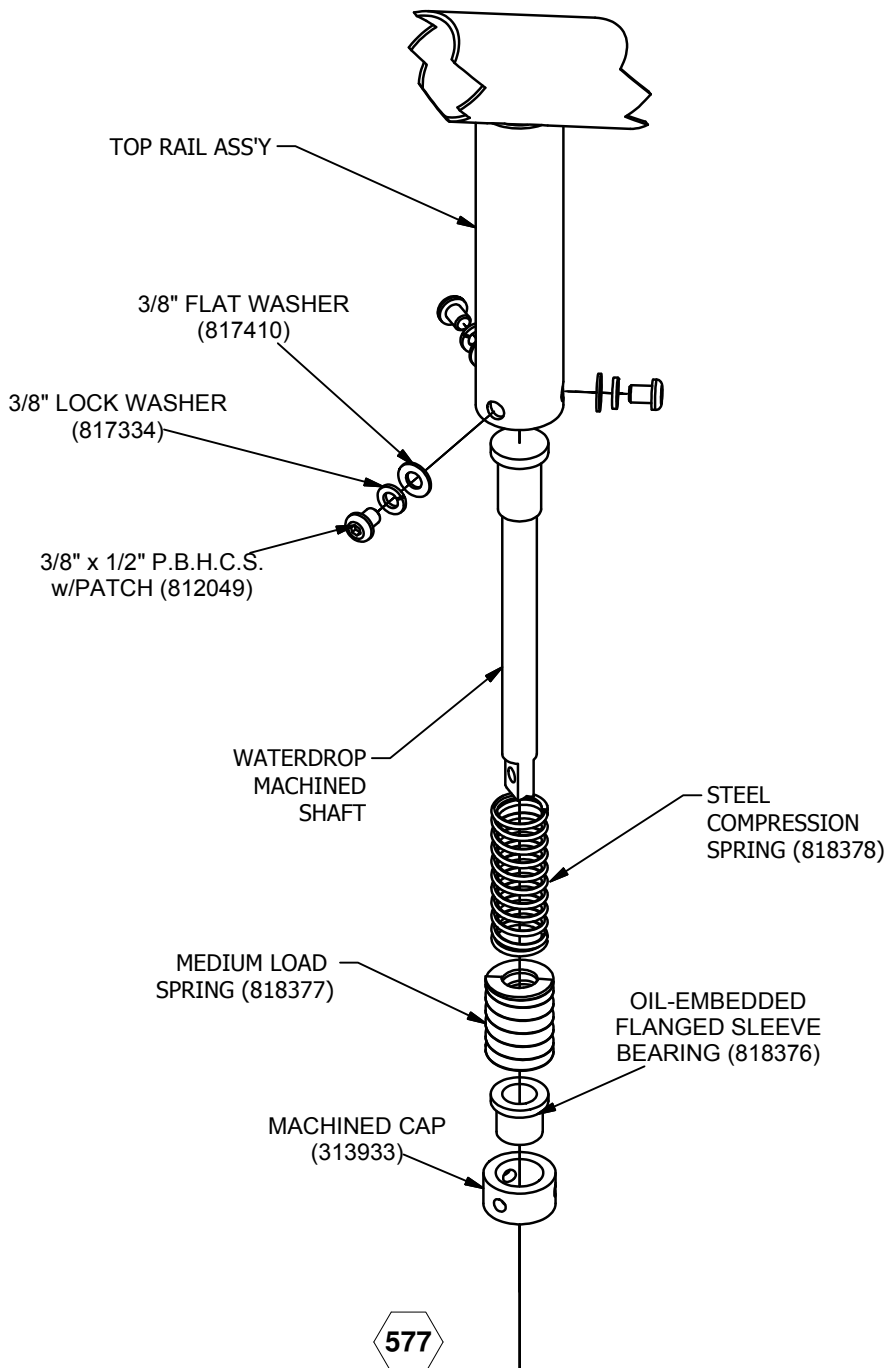
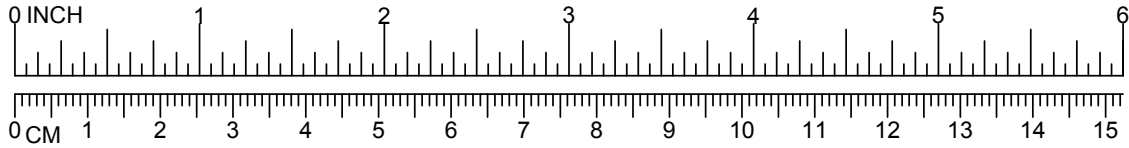

DETAILS -for- ASSEMBLY VIEW 3

IMPORTANT

TO REDUCE THE RISK OF CLOTHING ENTANGLEMENT IN COMPLIANCE WITH ASTM F1487, ANY BOLT END
PROTRUDING MORE THAN TWO FULL THREADS BEYOND THE FACE OF THE NUT SHALL BE CUT-OFF FLUSH, FILED
SMOOTH AND TREATED TO PREVENT CORROSION.

NOTE: LOCTITE (SUPPLIED BY OTHERS) SHOULD BE USED ON ALL THREADED HARDWARE.

NOTE: AFTER ASSEMBLY IS COMPLETE, PEEN TEE-NUTS AND FLATWASHERS TO MATCH RADIUS OF PIPE.

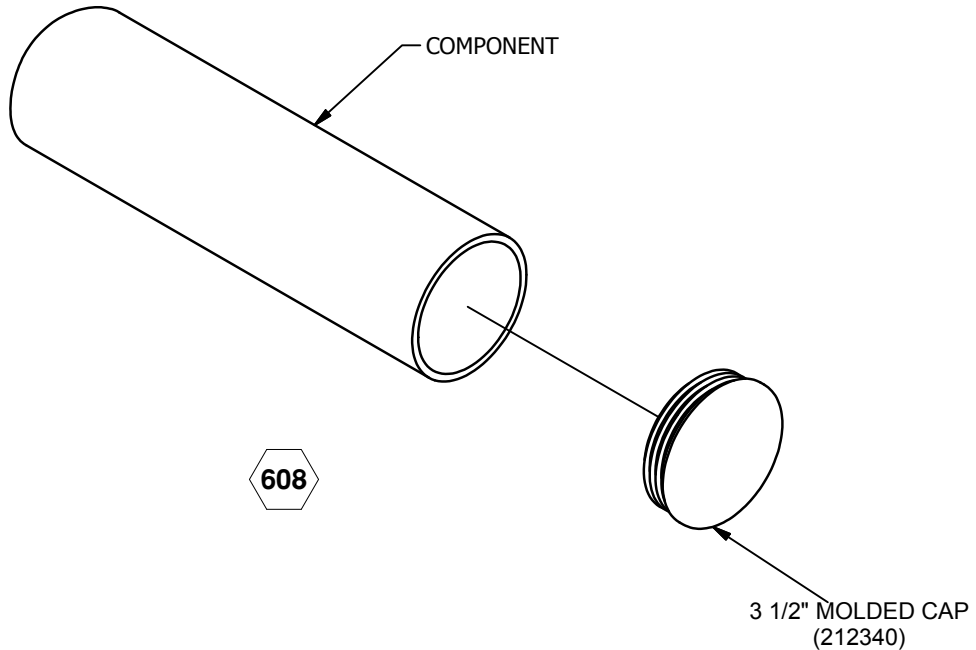
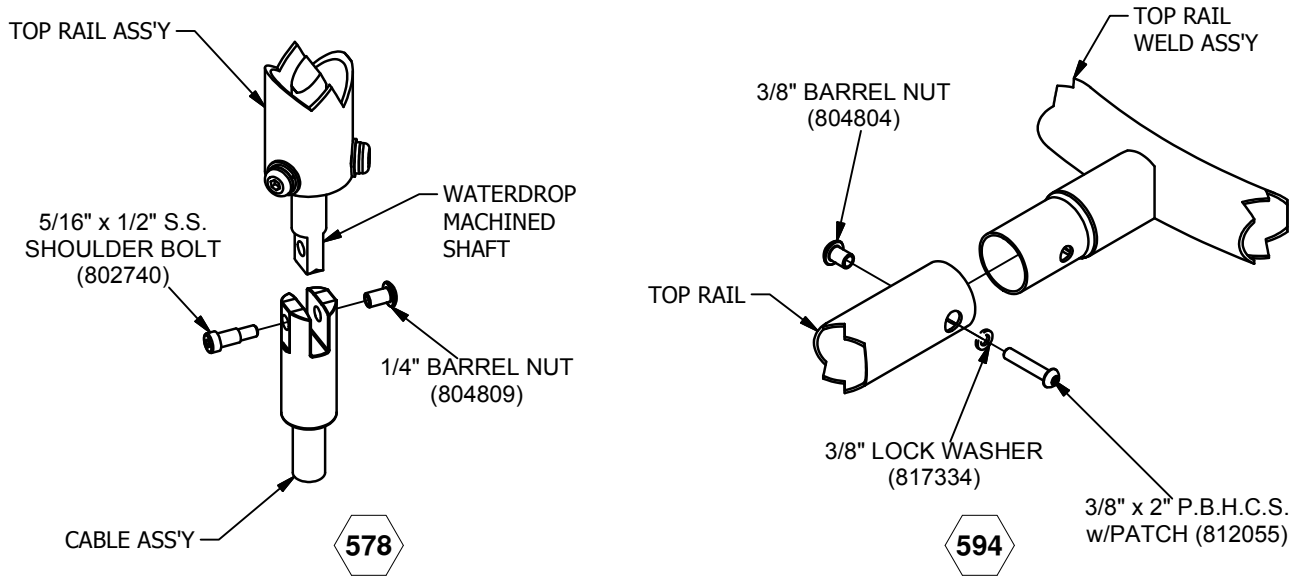
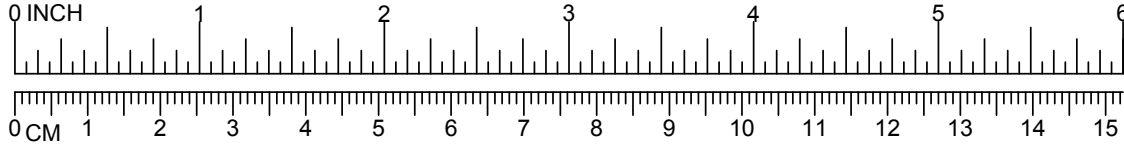

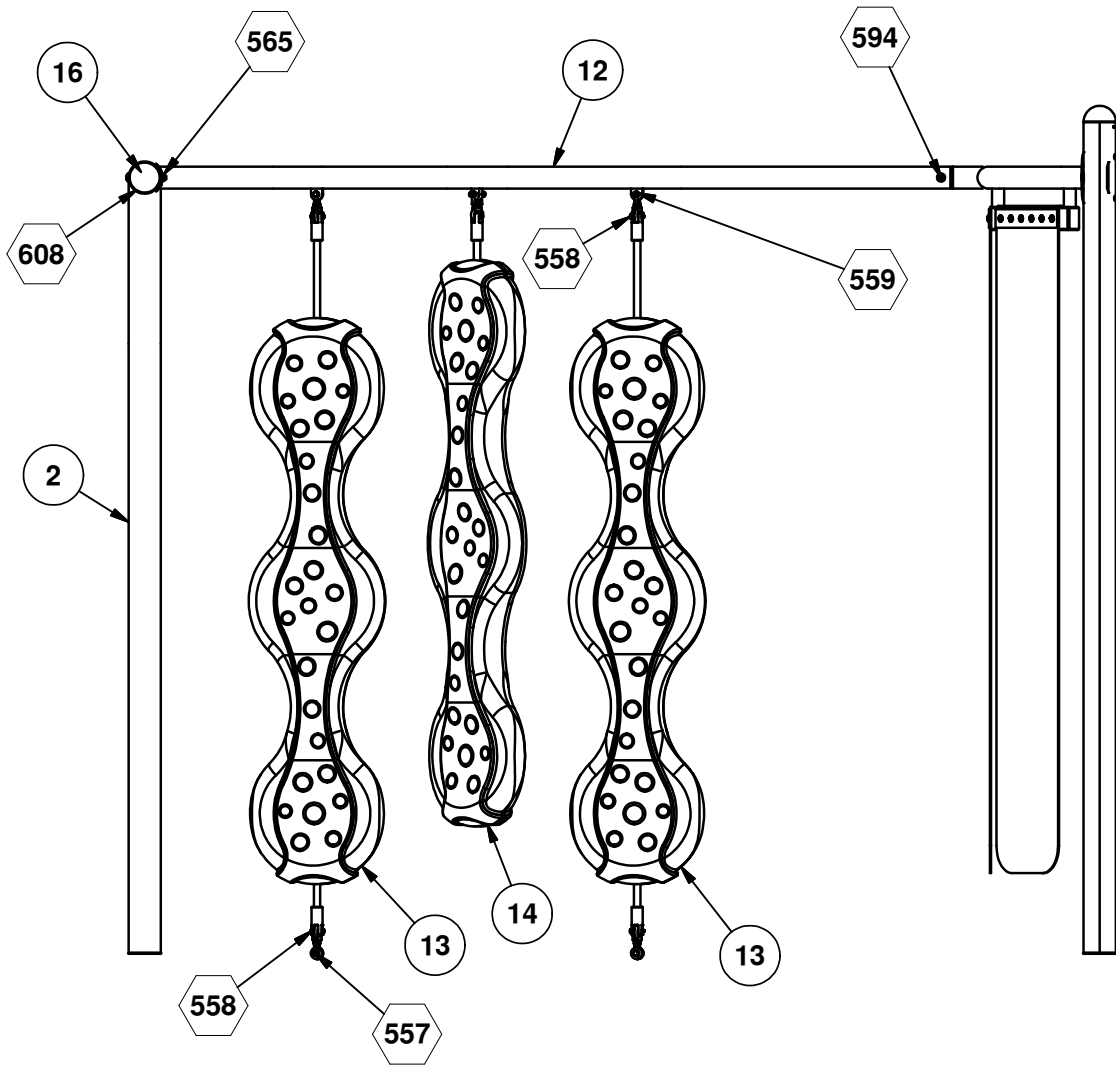

ASSEMBLY VIEW 4

DETAILS -for- ASSEMBLY VIEW 4

IMPORTANT

TO REDUCE THE RISK OF CLOTHING ENTANGLEMENT IN COMPLIANCE WITH ASTM F1487, ANY BOLT END
PROTRUDING MORE THAN TWO FULL THREADS BEYOND THE FACE OF THE NUT SHALL BE CUT-OFF FLUSH, FILED
SMOOTH AND TREATED TO PREVENT CORROSION.

NOTE: LOCTITE (SUPPLIED BY OTHERS) SHOULD BE USED ON ALL THREADED HARDWARE.

NOTE: AFTER ASSEMBLY IS COMPLETE, PEEN TEE-NUTS AND FLATWASHERS TO MATCH RADIUS OF PIPE.

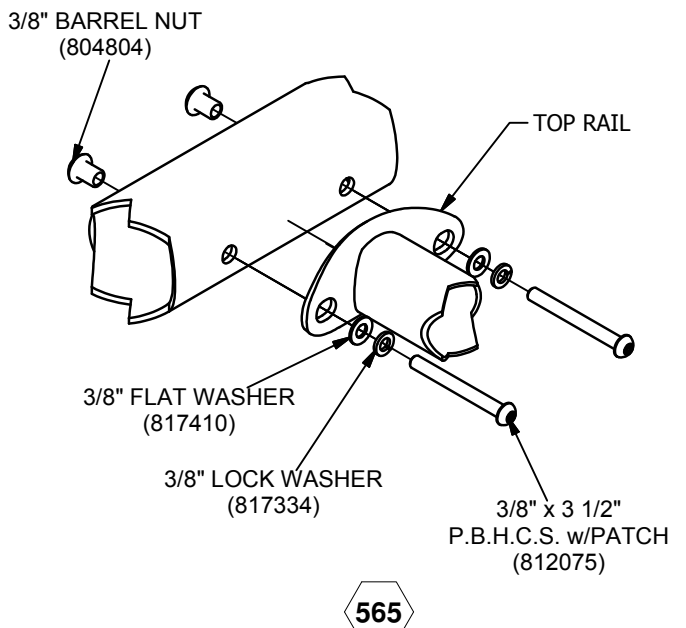
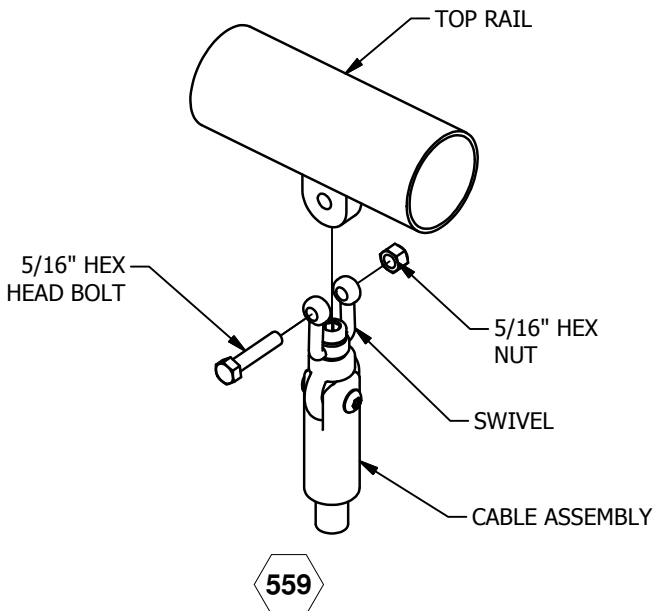
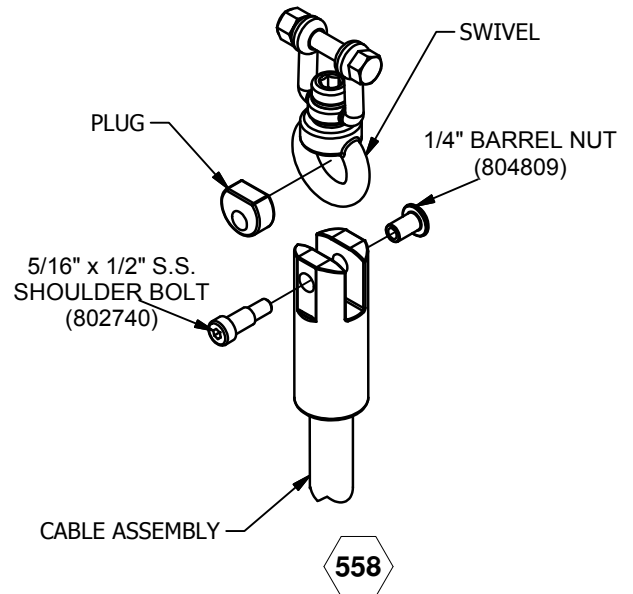
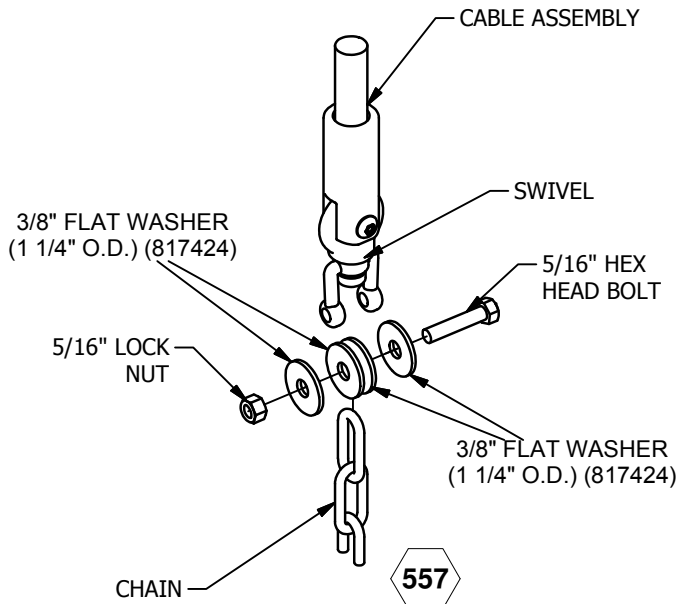
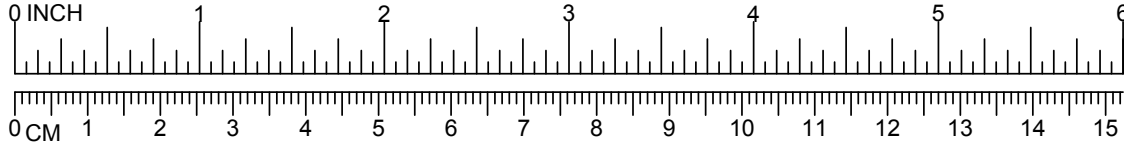

DETAILS -for- ASSEMBLY VIEW 4

IMPORTANT

TO REDUCE THE RISK OF CLOTHING ENTANGLEMENT IN COMPLIANCE WITH ASTM F1487, ANY BOLT END PROTRUDING MORE THAN TWO FULL THREADS BEYOND THE FACE OF THE NUT SHALL BE CUT-OFF FLUSH, FILED SMOOTH AND TREATED TO PREVENT CORROSION.

NOTE: LOCTITE (SUPPLIED BY OTHERS) SHOULD BE USED ON ALL THREADED HARDWARE.

NOTE: AFTER ASSEMBLY IS COMPLETE, PEEN TEE-NUTS AND FLATWASHERS TO MATCH RADIUS OF PIPE.

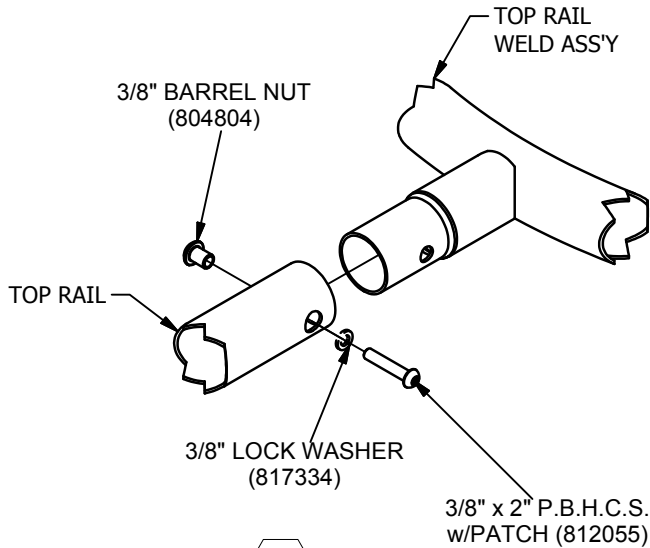
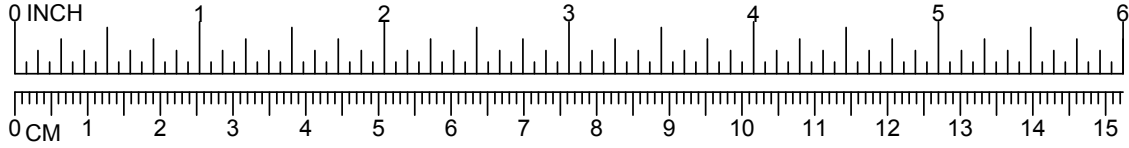

594

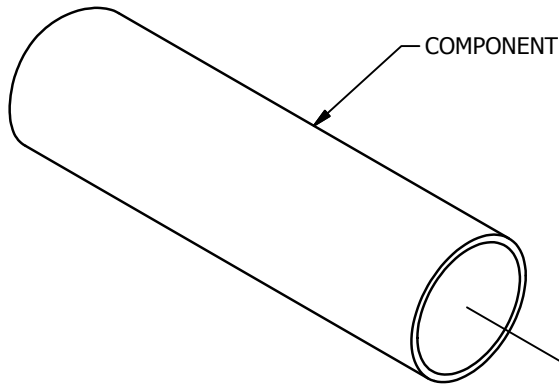

608

3 1/2" MOLDED CAP (212340)